

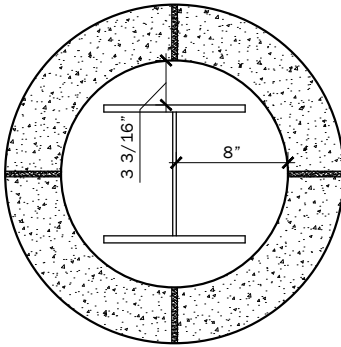

UL FIRE RATED

Design No. x902

Rating - 4 HR.



Steel Column - Minimum size W10x49 with minimum air space from web to block of 8 in. and from flange to block of 3 3/16 in. See above illustration.

Concrete Blocks* - Various designs. Classification D-2 (2 hr).

Thick Bed Mortar - Blocks laid in 3/8 in. thick bed mortar of cement-lime Type S masonry cement and installed with vertical joints staggered or unstaggered.

***Bearing the UL Classification Marking**