



UL FIRE RATED

## Design No. U913

**Bearing Wall Rating - 2 HR.**

**Nonbearing Wall Rating - 2 HR.**

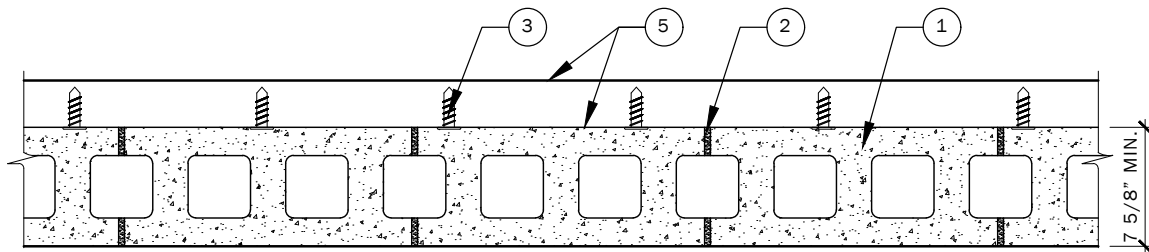

**Concrete Blocks\*** - Various designs Classification D-2 (2 hr).

**Mortar** - Blocks laid in full bed of mortar, nom. 3/8 in. thick, of not less than 2-1/4 and not more than 3-1/2 parts of clean sharp sand to 1 part Portland cement (proportioned by volume) and not more than 50 percent hydrated lime (by cement volume). Vertical joints staggered.

**Foamed Plastic\*** - Min 1 in. thick, density of 1 pfc max, polystyrene foamed plastic insulation boards, supplied in 2 by 4 ft sheets. Positioned horizontally and staggered 24 in. OC vertically, and attached to the concrete blocks (Item 1) with adhesive/base coat (Item 5) applied at a rate of 1-1/2 gal per 100 sq. ft.

Associated Foam Manufacturers - Type WSG

**Non-Metallic Fabric Mesh (not shown)** - Glass fiber fabric mesh, weighing approximately 2.5 oz/sq yd, positioned vertically over the foamed plastic (Item 3) and secured at the top with 16 gauge 3/8 in. long staples randomly spaced.

**Wall and Partition Facings and Accessories** - Coating System - The base coat is trowel-applied over glass fiber fabric mesh (Item 4) at a rate of 2 gal per 100 sq ft. The textured wall finish is then applied over the base coat at a rate of 2-1/2 gal per 100 sq. ft.

Gaco Western Inc. - Types A-5200, -5207, -5214, -5216, -5218, -5250.

**\*Bearing the UL Classification Marking**